

**RARE EXECUTIVE OFFICE SPACE IN UPTOWN
285 17TH STREET, OAKLAND, CA**



Highlights:
Rare small executive office space
On-site Parking Available
Elevator Served office space
Secure Building Entry
Operable Windows
Within 3 blocks of 19th Street BART
Under New Ownership

Presented By:

Brad Banker

BRE:01985920

bbanker@lcbassociates.com

510-763-7090 ext. 215

Steve Banker

BRE:00577218

sbanker@lcbassociates.com

510-763-7090 ext. 206

LCB
ASSOCIATES

SPACE DESCRIPTION

(As Measured: May 2010)

S.s.f.

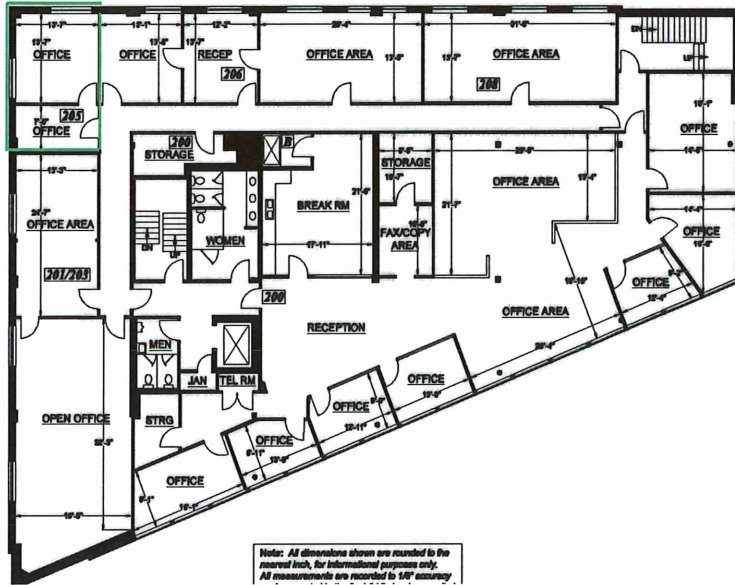

Available Suites:

Suite 205: 374 rentable square feet

**Asking rent: \$3.25 PSF Per Month on a MFS basis
(In-suite Janitorial not included)**

Two Parking spaces available for an additional \$200 per month per space

The John L. Moore Building was constructed in 1951, with unique Mid-Century Modern architecture. The building features a secured lobby entry, elevator and stair access to the upper floors, an on-site gated parking lot, HVAC to all floors, and operable windows throughout.

Suite 205 offers an extremely desirable layout, with area for reception and a large executive office space. This layout is perfect for attorney's, accountants, and therapy users. Operable Industrial style windows add additional character to the space.

The subject property is located in Bustling Uptown Oakland. With BART access a mere three blocks from the subject property, this space offers both employee's and clients easy access. Many hip and unique eateries are located in the neighborhood including: Burma Bear, Modern Coffee, Liba Falafel, Pho 84, and Beauty's Bagels (coming soon).

Presented By:

Brad Banker

BRE:01985920

bbanker@lcbassociates.com

510-763-7090 ext. 215

Steve Banker

BRE:00577218

sbanker@lcbassociates.com

510-763-7090 ext. 206

LCB
ASSOCIATES